

Advance Micromax™

20DD & 20DC

Walk-Behind Automatic Scrubbers



The Advance Micromax™ 20DX – value priced compact automatic scrubbers with interchangeable scrub decks.



Advance Micromax™ 20DD & 20DC

Walk-Behind Automatic Scrubbers

Value Priced Compact Walk-Behind Automatic Disc and Cylindrical Scrubbers with Traction Drive

The Micromax™ 20DX walk-behind automatic scrubber with traction drive is two machines in one! Designed as an alternative to larger scrubbers, the compact value-priced Micromax 20DX is Advance's first 20 inch traction drive scrubber that accommodates both rotary disc and cylindrical brush scrub decks.

The rotary disc is ideal for deep cleaning while the unique cylindrical brush provides sweeping and scrubbing at the same time, plus its interchangeable, modular, tools-free scrub decks can be easily changed

within minutes. That translates to cleaning flexibility, ease of service, and reduced inventory!

The self-propelled Micromax 20DX reduces operator fatigue and increases productivity. The Micromax 20DX holds 9.6 gallons of solution/recovery in the heavy-duty polyethylene tanks.

One pass with the Micromax 20DX leaves floors clean, dry, and ready for foot traffic due to its patented Smart Solutions™ setting- which takes the guesswork out of water control. By regulating the right amount of water for the job, operator safety increases and drying time decreases.

The Micromax 20DD is ideal for a variety of commercial scrubbing applications. Equipped with an interchangeable scrub deck-easily maneuvered by a foot pedal-operators can use the Micromax 20DD for numerous cleaning tasks. In addition, its time saving hands-free scrub head replacement technology ("click on"/"click off") can be activated by simply turning the scrub switch on or off.

At the heart of the Micromax 20DC is a unique cylindrical scrub brush that can sweep and scrub in one pass. This dual multitasking function is ideal for light industrial or small manufacturing facilities where debris pickup is important. Unlike a disc brush, the cylindrical brush picks up large debris and deposits it into a hopper to prevent jamming the squeegee or vacuum hose. Just imagine the additional square footage you can clean by eliminating the need to pre-sweep or mop.

In keeping with the Total Clean™ philosophy, the Micromax allows complete and easy access to all machine components. Total Clean features result in lower total cost of ownership and increased productivity to drive down the cost to clean.

Ideal Applications Include —

- Small Grocery
- Schools, Colleges and Universities
- Healthcare Facilities
- Small Manufacturing
- Commercial Buildings
- Office Buildings



VALUE FEATURES



Click-off/Click-on scrub heads save time and effort.



Low profile design for maximum visibility and maneuverability.



Easy access to batteries and other components assures minimal down time.



Hospital-quiet 65 dB A sound level for safe operation in any environment.



Click-off/click-on scrub heads for hands-free scrub head attachment and removal (DD model)



Cylindrical brushes are removable without tools



Easy access to onboard charger. Wet-acid batteries are standard. Gel batteries are optional

Fully adjustable, wrap-around ergonomic handle for optimal comfort and safety

Hospital-quiet 65 dB A sound level for safe operation in any environment

9.6 gallons of solution and recovery capacity in ultra-compact, "tank within tank" layout for maximum productivity



Squeegee features no-tools rotation and replacement of rear squeegee blade (4 usable edges)

Offset and low profile scrub head for edge cleaning

High traction tires for improved performance and safety

Dual counter rotating brushes pick up debris in one pass



Large recovery tank cover provides complete cleaning access of recovery tank and vacuum shut-off float

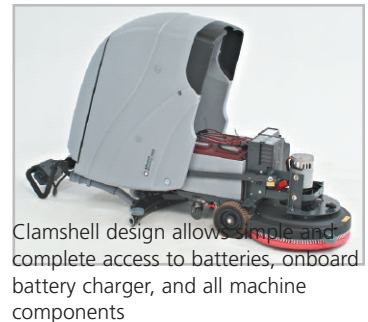

Clamshell design allows simple and complete access to batteries, onboard battery charger, and all machine components

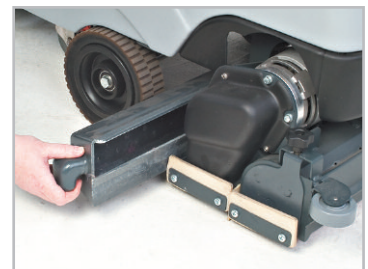

Hopper on Micromax 20DC easy to remove and empty

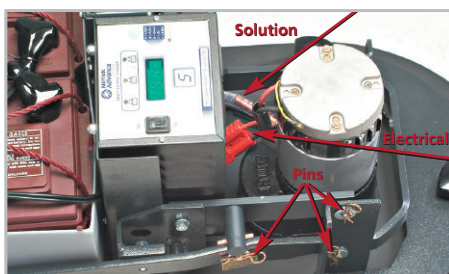

Tools-free interchangeable scrub decks between 20DD and 20DC



Smart Solutions setting provides a precalibrated flow rate for highly productive scrubbing. Variable solution flow (right) provides a customized flow



VALUE FEATURES



The Advance Micromax™ value - priced traction drive scrubbers with interchangeable scrub decks.

Defining Cleaning Innovation...

- Our products are designed using innovative technology that increases productivity and drives down the cost to clean.
- You can get expert service and maintenance for your Advance machines from factory-trained personnel around the world. Fast parts delivery, too.
- Maintain peak performance with Nilfisk Genuine OEM Parts.

Nilfisk Genuine OEM Parts

Optional Accessories

- Maintenance-free, Gel Batteries
- Multiple Brushes for All Applications
- Oil Resistant Squeegee Blades

- **Micro** – Low price, compact design
- **max** – High productivity, superior quality, premium features

Technical Specifications

	Micromax™ 20DD	Micromax™ 20DC
Scrub Path	20 in (51 cm)	20 in (51 cm)
Max Productivity Per Hour	22,000 ft² (2,044 m²) @ 2.5 mph/ 4 kph	22,000 ft² (2,044 m²) @ 2.5 mph/ 4 kph
Scrub Deck	Rotary Disc (tools-free interchangeable disc/cylindrical)	Dual Cylindrical Brush with Debris Hopper (tools-free interchangeable disc/cylindrical)
Scrub Head(s)	(1) 20 in (51 cm) disc	(2) 4.33 in dia x 19 in (48 cm) cylindrical brushes
Power Source	(2) 12 V batteries 130 Ah wet or 98 Ah gel (onboard charger)	(2) 12 V batteries 130 Ah wet or 98 Ah gel (onboard charger)
Brush Speed	170 rpm	570 rpm
Brush Pressure	65 lb (29.5 kg)	67 lb (31 kg)
Brush Motor	0.68 hp (510 W)	(2) 0.54 hp (400 W)
Solution System	Gravity feed, variable w/ Smart Solutions™	Gravity feed, variable w/ Smart Solutions™
Solution Tank	9.6 gal (36 L)	9.6 gal (36 L)
Recovery Tank	9.6 gal (36 L)	9.6 gal (36 L)
Vacuum Motor	0.51 hp (380 W)	0.51 hp (380 W)
Sound Level	65 dB A	65 dB A
Drive System	Variable speed, forward drive up to 2.5 mph (4 kph)	Variable speed, forward drive up to 2.5 mph (4 kph)
Drive Motor	0.17 hp (130 W)	0.17 hp (130 W)
Length	50 in (129 cm) - extended handle	48 in (122 cm) - extended handle
Width (w/o squeegee)	20 in (51 cm)	23 in (59 cm)
Height	34 in (86 cm) - top of tank	34 in (86 cm) - top of tank
Squeegee Width	30.3 in (77 cm)	30.3 in (77 cm)
Weight	360 lb (164 kg) w/ std batteries	370 lb (168 kg) w/ std batteries
Part Numbers	56 302 331 56 302 332	56 302 333 56 302 334

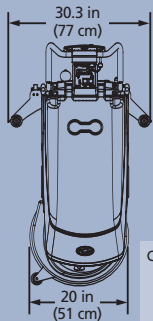
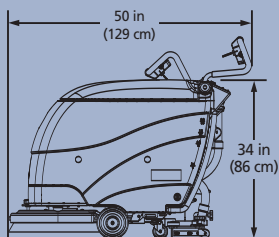

Cylindrical Model
Length
48 in (122 cm)
Width
23 in (59 cm)

Specifications are subject to change without notice.



14600 21st Avenue North
Plymouth, MN 55447-3408
www.advance-us.com
Phone: 800-850-5559
Fax: 800-989-6566

396 Watline Avenue
Mississauga, Ontario, Canada L4Z 1X2
www.nilfisk-advance.com
Phone: 800-668-8400 or 905-712-3260
Fax: 800-263-5111 or 905-712-3255